

## Adaptor Pillar

The NR2 non-rotatable support is an adaptor pillar that is used for installing the MMN-1 manipulator to an illumination pillar mounted type adaptor. However, this is not all. We will discuss alternative usage of the NR2 in this issue.

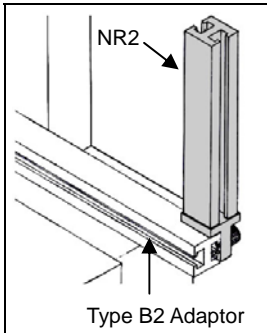

### ◆◆ What is the NR2? ◆◆

The NR2 is an adaptor pillar that is used in combination with the type B2 adaptor to change it to a type B adaptor. Originally, the MMN-1 was not designed to be installed to a type B2 adaptor. However, when the NR2 is attached to a type B2 adaptor, it allows the MMN-1 to be mounted on it.

Adding to it...

★ There is more to the NR2, as Narishige products are well suited for wide application!! ★

### ◆◆ Application to Stage-side Adaptor ◆◆

When a mechanical manipulator such as MN-151, MM-3 or UM-3C etc. is installed to a microscope, a stage-side mounted type adaptor is required in principle. However, the stage-side mount adaptor is not always available. The NR2 can be reassembled to a different shape to help in such cases.

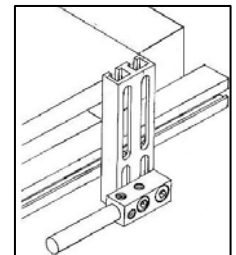

<Applying Procedure>

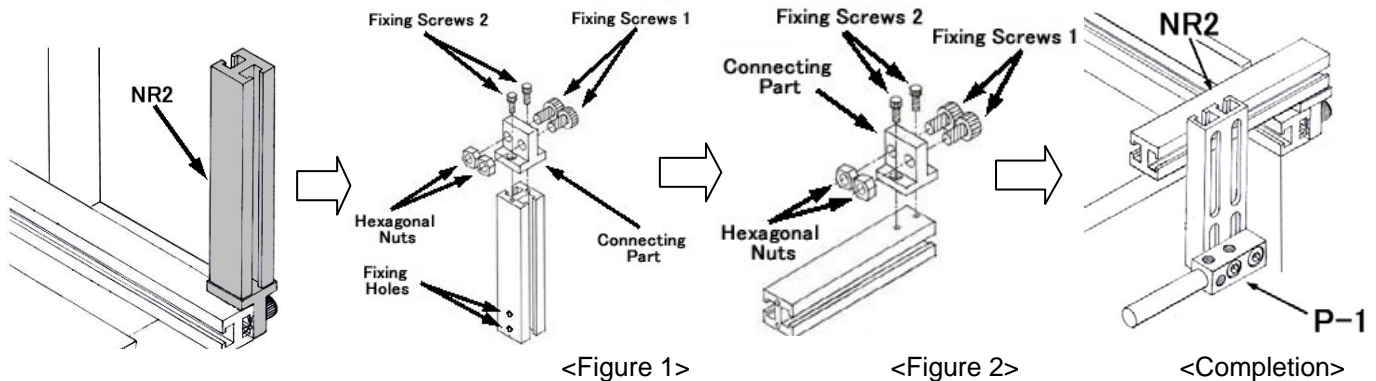

- I . Loosen the fixing screws 1 on NR2 and remove the hexagonal nuts from the screws. Then, loosen the fixing screws 2 and detach the connecting part. (See Figure 1)
  - II . Place the connecting part on the fixing holes on NR2, and fix it with the fixing screws 2. Then, put the fixing screws 1 in the connecting part and also the hexagonal nuts in the back. (See Figure 2)
  - III . Put the hexagonal nuts in the groove of the mounting adaptor attached to the illumination pillar, and fix it in the best position. This way it serves the purpose of a stage-side mount adaptor. Finally, put the P-1 (vertical adjustment plate) on the stage-side mount adaptor to install a mechanical manipulator.
- ※By setting the NR2 on the bottom side of the adaptor, vertical position can be altered.

**This way it serves the purpose of a stage-side mount adaptor, not by special order.**